

Felsham & Gedding

VILLAGE NEWS

Issue 208, June 2021



Welcome to the June edition of your Felsham & Gedding Village News.

We seem to have waited a long time for summer to arrive and the temperature to improve and at the time of writing we are still waiting – although I can't complain about the much-needed rain that finally arrived in May. But did we really need all of it? I do wonder if we are ever truly satisfied with the weather!

I do need to extend an apology for the mistake with the bin dates for May. I obviously got distracted part way through setting them up and the rest of the editing team also failed to spot my mistake. Needless to say, I have checked June's dates and bin types several times and hope that I have got it right for this month.

Our Village Hall Committee have been busy during the past year and have some good news to share for both the Village Hall and the Community shop. See page 5 for more details.

I'm sure like me you are all anxiously waiting for the 21st June to arrive – will all our restrictions be finally lifted? What will the “new normal” be like? I am particularly anxious about socialising in crowds, and yet I really want to as well – so that is going to be something for me to work through.

Take care and I look forward to tentatively socialising with you all again.

Jo

Next Copy Date: 20/06/2021

Please be aware that items submitted after the deadline cannot be guaranteed to appear in the magazine.

Copy Submissions

Email: fgvillagenews@gmail.com or call Jo Tavernor on 01449 737793

Advertising

Email: fgvillagenewsadverts@gmail.com or call Jo Tavernor on 01449 737793

Compliments, Complaints and Suggestions

The Village News welcomes your feedback. Do you have any comments about what we do, what's going well, anything you'd like us to change?

Newsletter General Policy

We do publish acknowledgements, articles of general interest, artistic works and similar.

We do publish factual material from recognised organisations.

We do publish to the Village Website at <http://felsham.onesuffolk.net>

We do not publish defamatory, rude, blasphemous, racial or other inappropriate material.

We reserve the right to edit contributions to suit publication needs.

We are reliant on contributions from many sources, taken in good faith, and cannot be held responsible for any errors or omissions.

Copyright waiver is presumed implicit on all submissions unless clearly stated otherwise.

The Local Housing Needs Survey

Felsham Parish Council recently asked everyone to complete a Local Needs Housing Survey. We have now received the analysis of the completed replies, a summary of which is below. The number of completed surveys is slightly disappointing but those who took the time to reply have shown us that there is a need for Local Affordable Housing in Felsham and the Parish Council are committed to looking into providing this if at all possible.

Felsham Housing Survey 2020

Executive Summary & Key Findings

Felsham Parish Council carried out a Housing Survey to determine the level of need for housing across all tenure types in the parish.

The aim of this survey was to understand the existing and future housing needs for Felsham residents including family members (not necessarily living in Felsham) and other members of the household. The study was also designed to understand Felsham current housing stock and whether this is affordable to local people.

This study included-

- General information about the current housing in Felsham including 2011 Census data
- A Housing Survey to determine the housing needs of current households
- Contextual information about Felsham
- Information from the Gateway to HomeChoice register to cross check the findings

Data analysis and the writing of this report have been undertaken by Community Action Suffolk.

Key Findings

	Number	%
Surveys Returned Completed (full or partial)	49	25
Surveys Not Completed or Returned or Blank	147	75
Total Surveys Distributed	196	100

The Felsham Housing Survey 2020 achieved a 25% return rate, with respondents in favour of homes for older people, small family homes and homes for couples.

From the 49 surveys returned, 10 households responded that the current households have identified a current need totalling 13 people.

From the 49 surveys returned, 2 of those households responded identifying a need for 3 family members (people with a local connection) wishing to live in or return to Felsham.

In total, the response from 12 households identified a housing need for 16 people in Felsham. This report has been compiled based solely on the data from the responses received. These figures may change throughout the report depending on the number of questions completed.

PROFESSIONAL FOOT HEALTHCARE
IN THE COMFORT OF YOUR OWN HOME

FRIENDLY AND PROFESSIONAL
TREATMENT AND ADVICE

TEL. 07842 400302

Email: tishfayers@hotmail.co.uk

Patricia Fayers S.A.C.Dip. RFHP

★ Professional finish at reasonable rates

★ Clean and tidy lady decorator

★ Honest, reliable service



Contact Claire Marks

Tel: 07895 277357

Email:
claire.marks@housetohomedecorating.co.uk

Web: www.housetohomedecorating.co.uk

A N GILLAM

Building,
All aspects of roofing,
chimney work,
Lime plastering & rendering.
Chimney sweep

*Free quotes,
No job too small,*

The Mouse House,
Bradfield St Clare,
Bury St Edmunds,
Suffolk
IP30 0EL

Tel 01284 388508
Mob 07961 878564

Nicholson Executive Travel

Professional Chauffeur Service

- * Airports and Seaports
- * Business Travel
- * Any UK Destination
- * Accounts Welcomed

Tel: 01359 232648
07850 370465

Email: roger.nicholson1964@gmail.com

Good News for the Village Hall

The Village Hall has just received planning consent for a three-phase project to:

incorporate the community shop, provide for a café and additional storage with the café doubling as an evening meeting room facility, provide much improved toilet and kitchen facilities and expand the main hall requiring the main floor to be raised to the level of the current bar and kitchen floor – when the floor will be replaced and additional more flexible accommodation will be available.

Phase 1 will necessitate moving the recycling area to near the entrance of the car park (on the left). We will be planning a working party soon to install its new concrete base so any offers of help will be very welcome!! Phase 1 will also require us to install an overflow car park in front of the hall using Grasscrete as well as widening the path to the hall to better accommodate wheel chair users.

The aim of this ambitious and exciting project is to create a community hub for Felsham and Gedding and surrounding villagers. Fund raising is about to get underway so watch this space!

The complete planning application can be viewed on Mid Suffolk District Council's online planning portal under application reference no DC/21/01773, but the proposed layout is shown below.

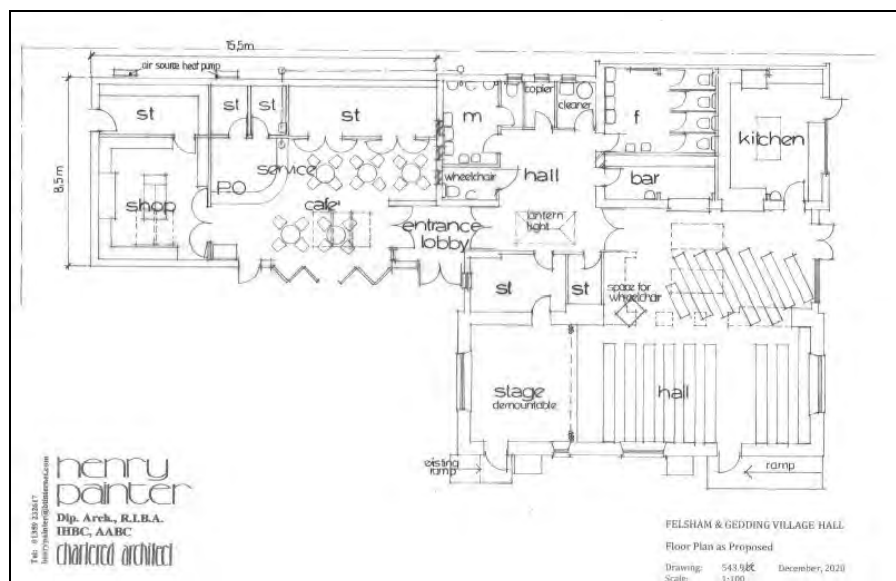

Any questions or offer of help – practical, technical or financial – please do get in touch with me or any member of the Village Hall Management Committee.

Whilst writing I would like to mention the Village Hall car park. Strictly speaking this car park is for the use of patrons of the Village Hall only. In the past by prior arrangement we have agreed for it to be used by residents if only to keep cars and vans 'off the street'. However there is a need for the car park to be vacated by users when we hold events or when, for example, the fish and chip van visits. For this reason I will be placing notices on vehicles for you to get in touch and register with us so we can contact you to advise when we need you to vacate the car park.

Andrew Conquest, Chairman on behalf of The Village Hall Management Committee
01449 737619

Felsham & Gedding Village Hall Management Committee

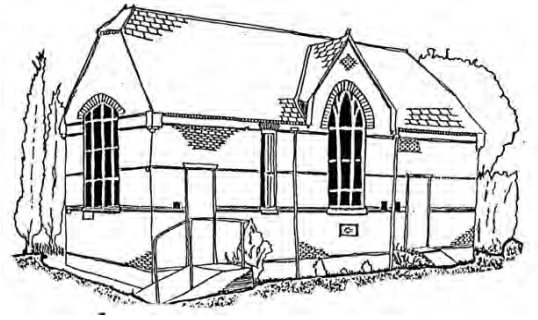

Year ended 31 March 2021

Chairman's report

This report is of my third year as Chairman of the management committee and what a challenging year for all. Since the first lock down in March 2020 we have lost all hiring income and have not had any opportunity to put on fundraising events in the Hall which hitherto have been the life blood of not just the hall but for the community as a whole.

The committee who have 'served' during the year have been David Simpson (Vice Chairman) Jo Hutchings (Secretary) David Williams (Bookings), Stephen Brookes (59 Club), Ken Sparkes (caretaker and Parish Council representative), Kayleigh Brookes, Tricia Wilson, Brian Francis, Mark Crawford, Gilly Morgan, Jamie French, Geoff Anthony, and Jordan Silver and Mary Carter was co-opted.

I would particularly like to thank Jo for her secretarial duties and for organising the Christmas raffle with Beryl Meed - what a stalwart of our two villages – (£421 raised) and to Stephen Brookes for managing the 59 Club during a difficult time for him (£376 surplus) and Ken Sparkes for the unpaid work he was able to do around the hall. Our thanks must also go to Mark Tavernor for fitting the new roof to our main shed, Geoff Anthony for hedge cutting and Adrian King's support from time to time on handyman assignments.

The hall, despite not being fully utilised, has continued to be cleaned to an excellent standard by Karen Hubbard along with quarterly window cleaning.

Also, during the year, we took the opportunity to landscape at the car park entrance but the major project which has been ongoing with the support in particular of David Simpson, David Williams and Brian Francis, is the preparation and submission of the planning application for the Hall extension and internal improvements. The application was formerly submitted in March and was approved in May. (see separate article on page 5).

In keeping with Government measures, we have recommenced our elite sport activities (Table tennis, Carpet Bowls and Whist) and holding of meetings from 17th May, subject to strict guidelines, with hopefully freedom to pursue normal activities from June 21st. We can then look forward to our next pantomime from Fagends where work on a new script has already begun!

Financials

In summary our income for the year of £23,473 exceeded our expenditure by £16,016 increasing our total funds to £25,345. Our general fund increased to £25,060 with £285 being a restricted fund – a donation in memory of Mrs Barbara Garrod.

We successfully applied for Covid grants receiving £21,708. The Felsham Parish Council has also donated £462 being 50% of the planning application fee. The Gedding Parish Meeting has now reformed, and the Hall has received a donation of £150.

During the year “Village Friends” which meets in the village hall set up projects for delivering food parcels to the lonely and those isolating. They applied for grant assistance from Mid Suffolk District Council and were awarded £500. The Village Hall as a registered organisation received the funds on their behalf.

Our repair and maintenance costs this year totalled £1466. This comprises annual maintenance costs of £832, roofing materials for the shed, and landscaping.

Budget for 2021/22

Our costs for next year are estimated at c £5700 including contingencies for repairs and Covid restart costs. We are also committed to pay (and have now paid) the balance of the agreed architects fees of £4000.

Our income that we can foresee is limited to recycling claims of about £450 and a promised grant towards the planning costs (the value of which is to be established). We have successfully applied for a Covid restart grant of £8000. It seems that the hall is therefore on a stable financial footing with funds to help support the future planned development.

At our annual general meeting held in May the following were appointed to the Management committee

David Simpson (Vice Chair),
David Williams,
Stephen Brookes,
Brian Francis,
Jamie French,
Jordan Silver,

Jo Hutchings (Secretary),
Ken Sparkes (caretaker and Parish Council rep),
Tricia Wilson,
Mark Crawford,
Geoff Anthony,
Mary Carter.

Andrew Conquest
Chairman for and on behalf of
The Village Hall Management Committee

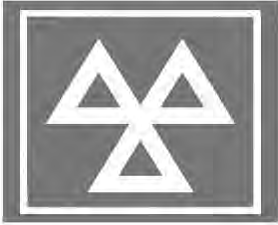

Rattlesden MOT **Centre**



Unit B Corern Farm
Woolpit Road
Rattlesden
Bury St Edmunds
IP30 0RZ

Contact: Tony 07908 464003 or Richard 07767 616188

Email: info@rattlesdenmotcentre.com

Class 4 & 7 MOT- Cars – Vans - Motorhomes

Keith Bedwell's Building Services

Traditional Lime & Hair Plastering
Plastering & Rendering
Floor & Wall Tiling
Renovation & Restoration Work
General Maintenance

Call: 01449 257806
Mobile: 07870 371520

Email: info@keithbedwell.co.uk
Facebook: Keith Bedwell Building Services
Website: www.keithbedwell.co.uk





VACANCY FOR PARISH COUNCILLOR

The recent resignation of one of our councillors has resulted in a vacant seat on Felsham Parish Council.

The Parish Council are now looking to co-opt a councillor to fill the vacancy.

NOBODY cares more about your community than you and your local council do!

Its residents, roads, services, airspace, countryside and developments

Are you over 18?

Do you live within three miles of Felsham or work here?

Are you on the Electoral Roll?

Are you interested in helping to improve the quality of life of your community?

Do you want to be involved in making important decisions in your community?

If you can answer yes to these questions then Felsham needs you.

Please contact the Clerk if you would like to be considered for the position or need more information.

felshamparishclerk@gmail.com

From the E-vine

The message below has been sent to me by a local resident:

You might be interested in the following. Recently we received a letter purporting to be from a Nicholas Ellis, Lime Walk, Felsham. It confidently promotes a new app called Neighbourhood Felsham, as a local hub for useful information such as local recommendations, lost pets, safety updates and much more. It says it's 100% free and private - just for our neighbours. If, however, you look at their website, and disregard the Trustpilot rating of five stars, read the reviews - they are scathing. "A burglar's charter," a rapists' charter, a turkey, etc.

Think carefully before signing up.

Big on quality and service - not so big on price

At R&A Graphics we produce quality, large format signs and graphics at competitive prices. We offer fast turnaround times and a design service for those who need it.

Using the latest UV print technology (including white inks) we help all sorts of businesses, charities, clubs, voluntary organisations and private customers get their message across. If you need any help or advice we're just a call or a click away.

Banners Canvas prints Pop-up displays Wall, floor & window graphics Social distancing signage	Vinyl labels & stickers Custom wallpaper Roller banners Backlit films Rigid signs Posters	
R&A Graphics Ltd Hollybush Farm Rattlesden Bury St Edmunds IP30 0SU Tel: 01449 736619 Email: info@randagraphics.co.uk		



Felsham & Gedding Village Hall

Available for hire

- Large Main Hall
- Separate room
- Fully Licensed Bar available
- Fully equipped Kitchen
- Stage available by arrangement
- Ample car parking
- Reasonable rates

For bookings call 01449 737778

WiFi available – password on request

June Events at Bradfield Woods

It's Suffolk Wildlife Trust's 60th birthday in June, and there are lots of events happening all over the county. Please book your place on events at suffolkwildlifetrust.org



Monday mornings Wild Tots

Monday afternoons Wild Tots and babies

Wed 2 Jun – Wild families: Suffolk Big 6 -A date with a dormouse 10.30am-12.30pm

Wed 2 Jun - Wild Teens: Trees & Whittling 2.30pm-4.30pm

Sun 6 Jun - Family spoon carving course 9.30am-12noon & 1pm-3.30pm

Mon 7 Jun - Green woodworking course, 6 weeks 6pm-8.30pm

Tues 8 Jun – Wild families: Go wild after school. Minibeast hunt. 4pm-5.30pm

WED 9 Jun - Fires & whittling for adults 10am-12noon

WED 9 Jun - Natural cordage for adults 2pm-4pm

THU 10 Jun - Walk: Tree ID - Stroll in the woods identifying trees. 2pm-4pm

Sun 13 Jun - Greenwood gallery: demonstrations, sales, family activities & refreshments 10am-3pm

Tues 15 Jun - Celebrating birch course. 10am-3pm

Tues 15 Jun - Woodland jewellery course 6pm-9pm

Thurs 17 Jun - Wild families: Go wild after school. Woodland fun, bring a picnic tea. 4.30pm-6.30pm

Sun 20 Jun - Big Wild Weekend: Father's Day woodland adventure 10.30pm-12.30pm

Thurs 24 Jun - Walk: Discover some of the woodland's wildflowers 2pm-4pm

Sun 27 Jun - Wild families: Suffolk Big 6 - Barn owl 10.30am-12.30pm

Sun 27 Jun – Wild families: Minibeast discovery 1.30am-4pm

ANNUAL Parish Report 2020-21

Councillor

Penny Otton.

Meadowside High Street Rattlesden, Bury St Edmunds IP30 0RA

Telephone: 07545423847

Email: penny.otton@suffolk.gov.uk



ELECTION: following the election I will again be part of a Green, Lib Dem and Independent group as this will have 15 councillors, we will be the second largest group and therefore the main opposition

Over the most challenging of years, the LDGI Group have worked hard to continue holding Suffolk County Council's administration to account. We have adapted to the new way of working on-line and have been present at every Scrutiny, Cabinet and Full Council, representing the people of our divisions.

Suffolk County Council Budget 2021-22

The Suffolk County Council Budget was voted through Full Council on February 11th. A council tax rise of 3.99%

LDGI Group Budget Amendment

The LDGI Group submitted a budget amendment to Full Council. The key change proposed by the LDGI Group was to authorise the use of the full 3% social care precept, unlocking the maximum available funding without impacting SCC's reserves. This would generate an extra £3.452m

Motions over the past year from the Liberal Democrat, Green and Independent Group

My Group proposed four motions to Council in 2020-21:

- A call for the Council to publicly oppose EDF Energy's proposed Sizewell C development and retract any 'in principle' support for nuclear power.
- A 20mph scheme to reduce speed limits in all suitable residential areas from 30mph to 20mph, for a price of £4m. Communities would have been able to opt out.
- A biodiversity motion that would implement a new biodiversity strategy.
- A carer's motion that will create a database of both paid and unpaid carers and offer increased support.

The first two motions were rejected, though the Council backtracked on Sizewell C just two months later and now states that they cannot support the build in its current form. The biodiversity motion passed.

Biodiversity strategy adopted

At Full Council on the 3rd December, Suffolk County Council unanimously passed a motion that will see Suffolk County Council developing a biodiversity strategy and embracing biodiverse land management practices. The motion was proposed by the LDGI Group and supported by all other groups.

LDGI Group motion on carer's database receives unanimous support

At Full Council on March 18th the LDGI Group presented a motion designed to improve the county's support offer for carers. The motion will see the Council working with Suffolk Family Carers to form an opt-in register for paid and unpaid carers, who will be offered increased support including advice, signposting to key services, and the option to be consulted on key policies affecting carers.

Calls for road closures during lockdown to enable walking & cycling

The LDGI Group called on Suffolk County Council to close roads that are used by residents to get their daily exercise, to ensure that walkers/cyclists can exercise safely and maintain social distancing.

Cabinet approves 5-year cycling plan for Suffolk

In June 2020 the Cabinet approved a 5-year cycling plan for Suffolk, which identified 148 potential routes to be prioritised. This is as a result of a motion proposed by the LDGI group in July 2018, which called on the council to produce a strategic costed 5-year cycling plan.

Climate emergency recommendations published

In July 2020, the Cabinet approved the recommendations of a cross-party policy development panel outlining how the council should respond to the climate emergency and reduce emissions. This followed a motion from the LDGI group in March 2019, which declared a climate emergency and committed the council to be carbon neutral by 2030.

Automatic number plate recognition camera project (ANPR)

Suffolk County Council is working with the police to run a 2-year ANPR camera trial in speeding hot spots across the county. The cameras will be used to help detect and deter speeding offences that have been highlighted in towns and villages and educate drivers on the importance of road safety.

An ANPR camera will be installed at a site where it has been identified by a local council, with support from their county councillor, so if Thurston wishes to do so I am more than happy to support.

MID SUFFOLK

SIX BELLS ; having called in the application I am obviously pleased that this was refused; thanks to all of you who contributed,

Again the council has agreed the council tax level,

The bin service was disrupted due to the weather, and COVID. You were not charged for any days the brown bin was not collected.

COST OF KEEPING OLD HQ SAFE; I have discovered it has cost £300,000 to just keep the old Needham building safe and secure!

JOHN PEEL CENTRE STOWMARKET; The council having bought the old Nat West building has agreed a long term lease with the John Peel Centre so that there can be a entrance from the High Street and give more space for activities and a café.

ALL VEHICLES TO BE CONVERTED TO HYDRATED VEGETABLE OIL. This will include refuse lorries and any other the council uses, as part of its bid to be carbon neutral.

COUNCIL BUYS ANOTHER RETAIL PARK; although the government has stopped the borrowing from the public Works Loan Board the council has purchased a business park in BASINSTOCK at the cost of £3million.

NEW CAR PARK AT WOOLPIT HEALTH CENTRE. A deal has been made with the developer to give land to the health centre to improve parking facility, which is overloaded particularly when doing vaccinations sessions.

SPANISH



Can you order your
"cerveza, vino y tapas?"



I CAN TEACH YOU!

Phone **Andrea**
on **01449 736955**

Friendly Experienced
Teacher
Offers
ONLINE

Individual MATHS Tuition (Speciality - Confidence Building)

Y7 – Y11 (GCSE)

Call Colin Plummer on
01449 736918

Or email colinp52@gmail.com
for details and availability

Valley Farm Piano and Cello Tuition



Experienced, qualified
teacher/professional accompanist.

Teaching all ages: beginners to advanced.



Accompanist for concerts, exams, rehearsals.

Contact: **Nicola Brazier.GRSM(Hons) ARCM LGSM**
Tel: **01449 737458**
Mob: **07531795064**
Email: nicobraz@hotmail.co.uk

ALTERNATIVE SERVICES

WINDOW CLEANING COMPANY

EST: 1991

We are a window cleaning company, have been around 20 years.

My name is Nigel.

If you would like a quote, please ring me or send an email.

Mob 07775 858052

Email nigel.mess22@ntlworld.com

RJP Maintenance

Robin Phillips at RJP Maintenance

Felsham based property and garden maintenance/ handyman
Fully insured and hold a waste removal licence.

Felsham and Gedding based works will receive a 15% discount on my day rate.

Please get in touch for a free no obligation quote.

07392 408552

Robinjackphillips@gmail.com

Facebook: @rjpmaintenance

CARGATE engineering

Septic Tank Emptying and Servicing

- Septic Tank and Cesspool Emptying • Tank and Drain Cleaning Service available • Reliable and Competitive • 24/7 Emergency Response
- Treatment Plant Service available • New Tanks installed
- Vehicles Covering East Anglia

Cargate Engineering Ltd.
Felsham Road, Bradfield St George,
Bury St Edmunds, Suffolk IP30 0AG

E-mail: n.milsom@cargate-engineering.co.uk

www.cargateengineering.co.uk



01284 386538 (Head office)

CHIMNEY SWEEP

ECO SWEEP CHIMNEY SERVICES

- NEW POWER SWEEPING METHOD USED FOR A MORE THOROUGH CHIMNEY CLEAN THAN BRUSHES.
- INDUSTRIAL HEPA FILTERED VACUUM.
- FULLY INSURED.
- INSURANCE RECOGNIZED CERTIFICATES ISSUED.
- SPOTLESS, RELIABLE AND FRIENDLY SERVICE.
- ALL CHIMNEYS, WOOD BURNERS, AGA, BOILER FLUES SWEPT.
- GUILD OF MASTER SWEEPS CERTIFICATED MEMBER.









TEL. 01359 232335

June 2021

Monday	Tuesday	Wednesday	Thurs
	1	2 Table Tennis, VH 7.30pm	John's Fresh Call 01449 Mermaid Fish VHCP – 6 –
7	8	9	John's Fresh Call 01449 Mermaid Fish VHCP – 6 –
14 John's Fresh Fruit & Veg Call 01449 736578	15 Parish Council Meeting 7.30pm	16 Table Tennis, VH 7.30pm	John's Fresh Call 01449 Mermaid Fish VHCP – 6 –
21 John's Fresh Fruit & Veg Call 01449 736578	22	23	John's Fresh Call 01449 Mermaid Fish VHCP – 6 –
28 John's Fresh Fruit & Veg Call 01449 736578	29	30	

VH = Village Hall
 VHCP = Village Hall Car Park

day	Friday	Saturday	Sunday
<p>3</p> <p>Fruit & Veg 736578</p> <p>& Chips 6.30pm</p>	<p>4</p> <p>Fresh Fish, VHCP, 10:05am</p> <p>Library Van, Gedding, 10.10am & VHCP, 11.40am</p>	<p>5</p> <p>REGGIA PIZZA, 4.30-8.30pm VHCP</p> <p>BLACK BIN</p> 	<p>6</p> <p>Trinity 1</p>
<p>10</p> <p>Fruit & Veg 736578</p> <p>& Chips 6.30pm</p> <p>BROWN BIN</p> 	<p>11</p> <p>Fresh Fish, VHCP, 10:05am</p> <p>RECYCLING BIN</p> 	<p>12</p>	<p>13</p> <p>Trinity 2</p>
<p>17</p> <p>Fruit & Veg 736578</p> <p>& Chips 6.30pm</p>	<p>18</p> <p>Fresh Fish, VHCP, 10:05am</p> <p>BLACK BIN</p> 	<p>19</p>	<p>20</p> <p>Trinity 3</p> <p>10am Family@Felsham</p>
<p>24</p> <p>Fruit & Veg 736578</p> <p>& Chips 6.30pm</p> <p>BROWN BIN</p> 	<p>25</p> <p>Fresh Fish, VHCP, 10:05am</p> <p>RECYCLING BIN</p> 	<p>26</p>	<p>27</p> <p>Trinity 4</p> <p>10am BCP, Gedding</p> <p>6pm Evening Celtic Communion, Felsham</p>

Church Services

Cockfield Benefice Services – June 2021

please see website for up-to-date information

All services are conducted in line with the coronavirus guidance issued by the Church of England, for more information visit

<https://www.churchofengland.org/resources/coronavirus-covid-19-guidance>

Wednesday 2 nd June	Wednesday Worship on Facebook
Sunday 6 th June Trinity 1	10am Communion – Bradfield St George 10am Communion – Cockfield (& online) 6pm Evening Prayer – Bradfield St Clare
Sunday 13 th June Trinity 2	8am Communion BCP – Cockfield 10am Morning Prayer BCP – Gedding 10am Communion Bradfield St Clare (& online)
Sunday 20 th June Trinity 3	10am Communion – Cockfield 10am Family@Felsham (& online)
Sunday 27 th June Trinity 4	10am Communion BCP – Gedding 10am Worshipping Together – Bradfield St George (& online) 6pm Evening Celtic Communion - Felsham

All online services are livestreamed on the benefice facebook page
at <https://www.facebook.com/cockfieldbenefice/live/>

A service of Celtic Morning Prayer is held every Tuesday at Cockfield at 9am

The prayer group meets every Wednesday at 2pm via zoom with the following link:
<https://us02web.zoom.us/j/86736217904?pwd=Y2VGK0UvQlpkZHFzTFE4NkE4bHFxQT09>
(Meeting ID: 867 3621 7904, Passcode: 456146 if needed).

Please note these services may be subject to change – for up-to-date service times see the benefice website at www.cockfieldbenefice.com

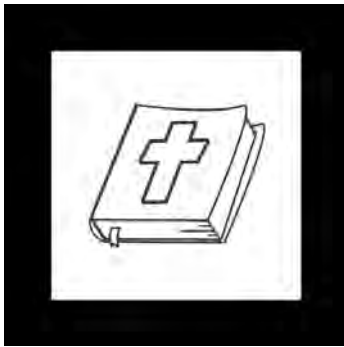

Dear Friends,

As I write this, we are facing another period of uncertainty around the 'roadmap' to coming out of lockdown. Who knows, by the time that you read this, we might be facing some further restrictions, or even a delay to all restrictions being lifted.

However, I am looking on the positive side and hoping that all the events that are being planned across the benefice will take place and that we will be able to shake hands once again or embrace those we have been separated from for so long.

I am also looking forward to the ordinations at St Edmundsbury Cathedral, when Helen Grover will be made deacon on Saturday 3 July. Helen is coming to the benefice to spend three years with us as a curate. We also pray for Mark Hinde, who will also be made deacon that day. Mark lives in Stanningfield parish, and Mark will also be curate with us from July. Our own Rev Richard Stainer will be ordained priest on Sunday 4 July. Your prayers for all who are being ordained at Petertide this year are much appreciated!

We will be opening all our churches across the benefice for services in June and I am looking forward to the services starting again at St Peter's here in Felsham. Do come along and join with us as we worship together once again. As well as our Family service, we will be trialling a new service in the evening, a more informal type of communion service using Celtic style prayer and words.

With every good wish in the best month of the year – when the roses bloom and the days are long!

Yours in Christ,

Sharon

Revd Canon Sharon Potter, Rector of the Cockfield Benefice,
Revsharon2@gmail.com; 01284 828599 or 07825 086063

ALL ASPECTS LANDSCAPING

Fencing Paving Treecare

WWW.ALLASPECTSLANDSCAPING.CO

CALL NOW FOR A FREE NON OBLIGATION QUOTE

Follow us on Facebook



We cover all hard and soft landscaping with many years of experience

**FENCING -DRIVEWAYS - PATHS AND PATIOS-BLOCK PAVING -
GARDEN GATES AND WALLS -TURFING AND SEEDING-GARDEN
CLEARANCES-DIGGER WORK -CURB STONES-ALL TREE WORK
AND HEDGE CUTTING-GRASS CUTTING LARGE/ SMALL AREAS**

01284 624089 | 07384351944



We are looking for volunteers for a Church Cleaning Rota for St Peter's Church, Felsham (hopefully this time we won't get Locked Down before we can get started). If you could spare an hour or two every few weeks and would be interested in joining the team please contact:

Tricia Wilson – Tel: 01449 736330,

Email: pawilson4@btinternet.com

We are also looking for people to help with flowers for the church, if you would be interested in join this team please contact:

Sue Jell – Tel: 01284 828892



The CleanPlumber

experience the difference

**Installations, Service & Repairs
Domestic & Commercial...**

- Gas, Oil and LPG Boilers
- Central Heating
- Power Flushing of Radiators
- Gas Safe and Oftec registered
- Showers & Bathrooms
- Property Maintenance

**A leaking tap to a brand new
system – we can help you**

Call us now on

01284 765453

www.thecleanplumber.co.uk

Apple Tree Cottage



**Locally Produced
Naturally Reared
Rare Breed**

Lamb-Hogget-Mutton

**Available from the Village Shop
and at
Apple Tree Cottage
Lower Green, Felsham**

Crawford Electrical Contractor



Mark Crawford

Domestic and Commercial Electrician

Telephone: 01449 736043 / 07811 897878

***CEC* Electrical**

Notes From a Small Farmyard

“I see you have quite a herd of goats”

Not the sort of comment I want my husband to hear... Our adventure into goat keeping in 2012 started with his arm being severely bent by the combined attack from a female friend and me. Being easy natured and not one to say “No” to the ladies he subsequently found himself being dragged to the flatlands beyond Colchester to pick up a dismantled second hand horse shelter which then needed returning to its three-D state prior to the arrival of “just two goats” (that being the minimum number to keep).

Then came the need for a covered, outdoor area for the precious two to enjoy the outdoors without getting wet.... And then a separate milking parlour so the milking bench would remain clean between milkings (they liked using it as a climbing frame when it was left in with them)... And then came the year we had a beautiful brown and white female kid born who “just had to stay” (she’s still with us – Princess Charlotte Elizabeth Diana is her full name but we shorten it to “Charlotte” so she doesn’t get ideas above her station).



The biggest shift was in 2018 when we were offered two rare pedigree English goats at which point I woke up to the fact that these lovely goats were in serious danger of extinction. Because my original goats (both also pedigree English) had been obtained relatively easily I had ignored the fact that I had never seen any anywhere else, or the reason why this might be the case. So finally, we joined the Breed Association and after a lot of searching found a billy in West Sussex. This was the only billy registered in 2018 which really does highlight the critical status of the English goat, and why I am now on a mission to educate and share the delights of not just goat keeping, but the keeping of English goats.

Of course, the arrival of a billy (Chestnut Finnemore) on our holding meant more work for Mark – the building of a billy shed (big enough for just one billy, naturally). However, now that I was part of the English Goat Breeders Association and registered as one of only 16 breeders in the country, in 2019 the opportunity to purchase a promising young billy was put in front of me. So Millwind Gambit arrived to keep Finnemore company, and the billy shed needed extending...



Chestnut Finnemore
(left)
Millwind Gambit
(right)



All our goats (apart from Charlotte) are registered with the English Goat Breeders Association and have pedigrees (just like pedigree dogs and cats). They have become part of the English Goat National Breeding Programme set up by the Association when the Rare Breeds Survival Trust accepted the breed onto their Watchlist in January 2020 and there is now a lot of work being done by the Association and the RBST to show the wider public what English goats are, and what they can do for today's farmers and smallholders.

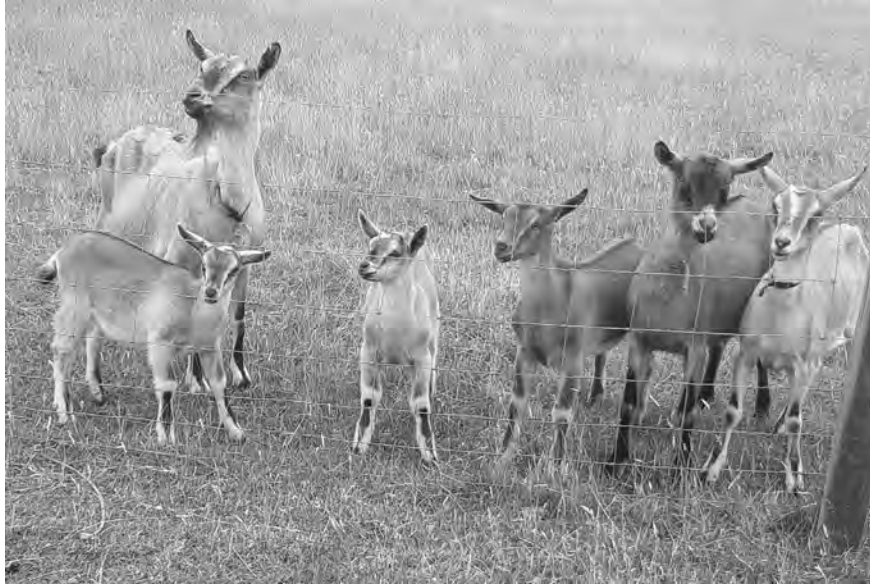

The Appletree Herd of Pedigree English Goats

Our now rather large herd of goats can be found behind the allotments in Felsham, along with Mark's masterpiece which we grandly call the "Goatel". It can house 6 adult females and 2 adult males but don't tell him that – he's still trying to work out how he got conned into having goats in the first place.

If you would like to know more about English goats then please take a look at the Association's website: www.egba.org.uk You may find Felsham is more famous than you realised!



The Goatel – A masterpiece of many additions
Felsham and Gedding Village News, Issue 208 June 2021

For The Kids

Colour in your favourite goat below.

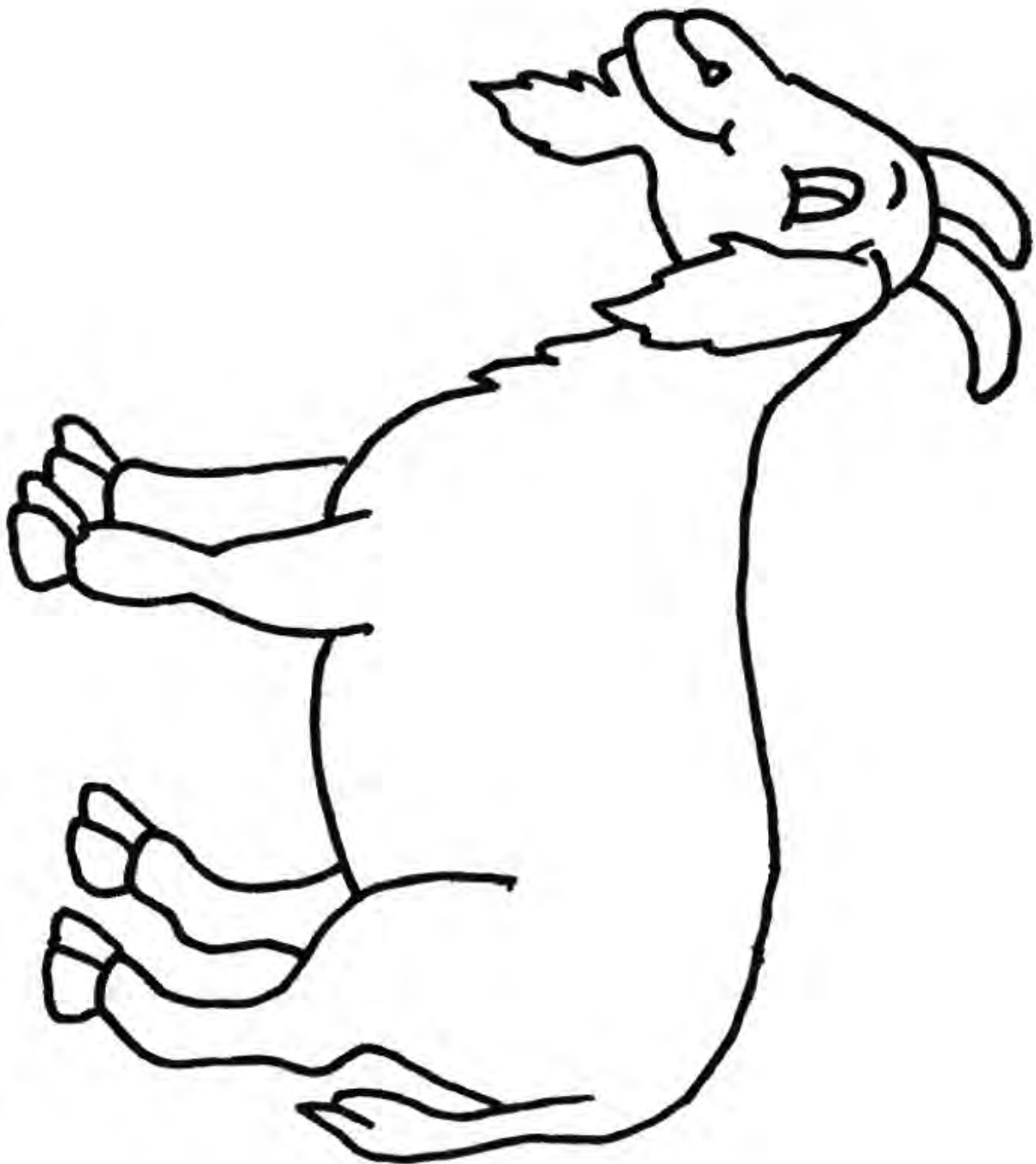

Lucy's Strawberry Slices

This recipe is from Mary Berry's Absolute Favourites. Lucy has worked with Mary Berry for 25 years and this is a twist on the classic Victoria sandwich. The slices look adorable and are, of course, divine to eat!



Equipment and preparation: for this recipe you will need a 30x23cm/12x9in traybake tin.

Preparation time: less than 30 mins

Cooking time: 30 mins to 1 hour

Serves: Makes 27 slices

Ingredients

For the cake

- 225g/8oz butter, softened, or baking spread, plus extra for greasing
- 4 free-range eggs
- 225g/8oz caster sugar
- 300g/10½oz self-raising flour
- 2 level tsp baking powder
- 4 tbsp milk
- 1 tsp vanilla extract

For the filling

- 2 tbsp strawberry jam
- 1 tsp lemon juice
- 300g/10½ oz small fresh strawberries, hulled and cut in half
- 300ml/10½ oz double cream, whipped
- 200ml/7fl oz full-fat crème fraîche
- icing sugar, for dusting

Method

1. Preheat the oven to 180C/160C Fan/Gas 4. Grease the traybake tin with butter or baking spread and line the base and sides with baking paper.
2. Measure all the cake ingredients into a large bowl and beat well using an electric mixer for about 2 minutes until well blended. Turn the mixture out into the prepared tin and smooth the surface.
3. Bake for 35 minutes, or until the cake has shrunk from the sides of the tin and springs back when pressed in the centre with your fingertips. Leave to cool in the tin.
4. Remove the cake from the tin and trim the edges so they are perfectly straight. Cut the cake lengthways into three strips, then cut across each strip to give nine 7x3cm/2 $\frac{3}{4}$ x1 $\frac{1}{2}$ in slices. Cut each slice in half horizontally ready for filling as you would a sandwich.
5. For the filling, spoon the jam into a bowl with the lemon juice and blend together, then toss the strawberries in the jam to give a glaze. Mix the whipped cream and crème fraîche together and spread or pipe a fairly thick layer over the base of each half-sponge. Arrange two or three glazed pieces of strawberry on top and sit the top half of the sponge on top. Dust with icing sugar to serve.

Recipe Tips

Prepare ahead: The cake on its own, without the filling, will keep well in an airtight tin for a day. Once filled, the cakes can be stored in the fridge up to 8 hours ahead.

Freeze: wrap the cake, without the filling, in cling film and foil and store in the freezer.

DO YOU ENJOY READING THE VILLAGE NEWS?

Would you like to have a go at editing it a couple of times per year?

The Village News is currently seeking additional editors to bring their personal slant to this very successful monthly magazine.

Editing a magazine takes about four hours in total, but this can be as flexible as you need it to be to fit in with your other commitments, and the number of times you commit to editing within the year is entirely up to you.

No previous experience of editing is necessary but some key computer skills such as copying and pasting into Microsoft Word and an internet connection are required, plus a desire to not be beaten by the occasional technical glitch. Full training and support will be provided.

Please contact either **Jo on 01449 737793** or **Tricia on 01449 736330** or email **fgvillagenews@gmail.com** if you would like more information.



Taylor's Solid Fuels LTD

Family run since 1946

**Regular fortnightly Solid Fuel deliveries in your area.
Competitive prices and a full range of products.**

"Don't Shiver We Deliver"

Quality top soils and aggregates. Bulk bags and Tipper loads from 1-20 tonnes

Tel: 01842890568 or see us on www.taylorssolidfuels.co.uk

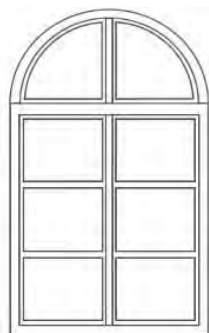

MILES ROLFE JOINERY

Production, Design & Fitting of All
Aspects of Joinery & Furniture

Gt. Finborough • Suffolk

07880 776845 mobile
mrjoinery@live.com

01449 771338 evening
milesrolfejoinery.co.uk

 Follow me on Facebook

Plastic bottle dog rose flowers

Have you seen any pretty pink dog rose flowers peeking out of hedgerows when you've been out and about? Have a go at painting these lovely little flowers using a plastic bottle before it heads into the recycling.

1. Simply gather together some card, pink, purple and yellow paints and your bottle.
2. Mix your pink and purple paints together ever so slightly to create an almost marble effect.
3. Dip the base of your plastic bottle into your slightly-mixed paint.
4. Then, simply use the bottle to stamp on your card.
5. Do it a few times to make a selection of flowers, and then add a yellow circle in the middle of each flower to finish it off.
6. Feel free to add some leaves and stems too, or leave your masterpiece as is.

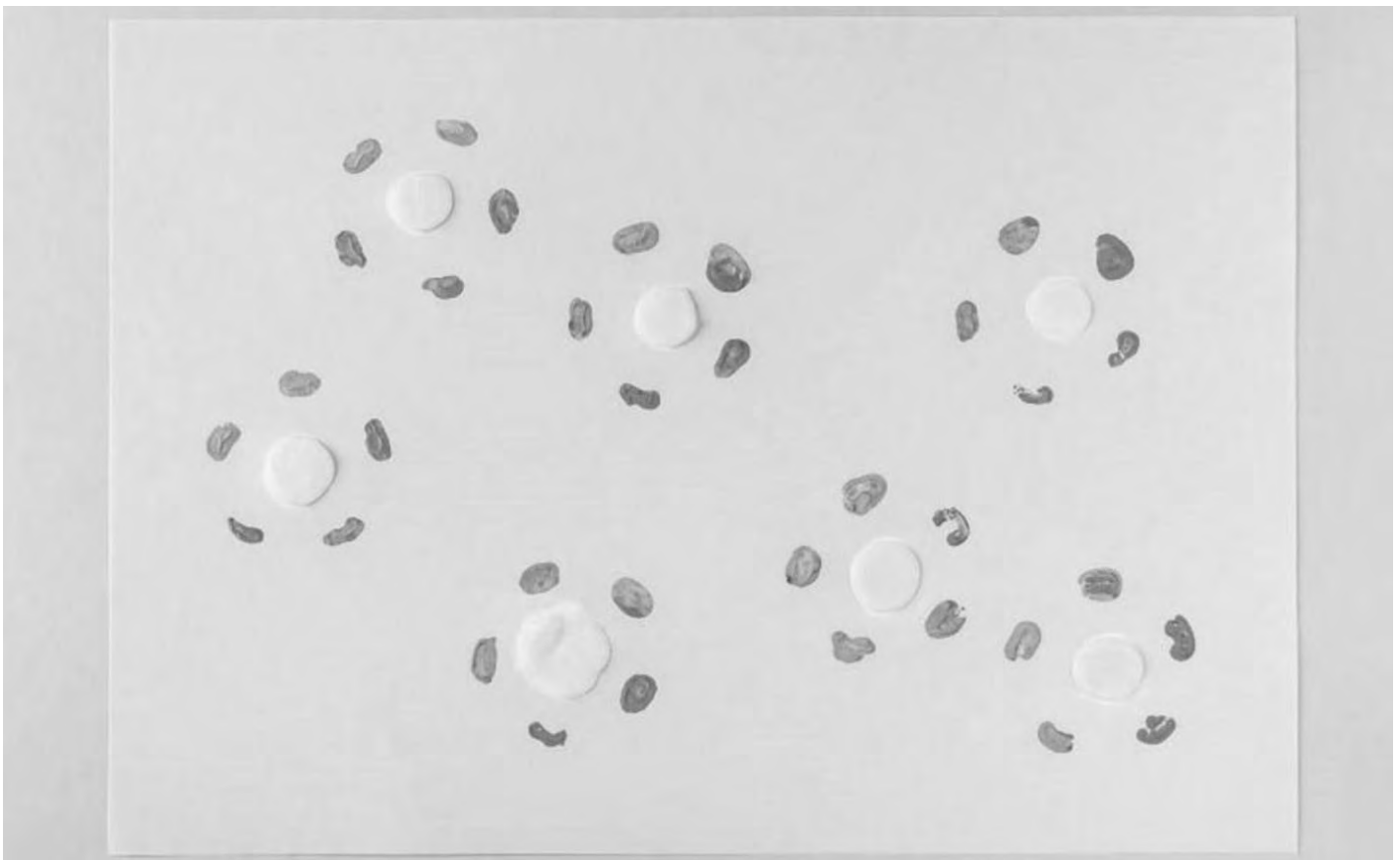

Rothwell's Carpet Cleaning

01638 428 060
www.Rothwells.biz

Carpet Cleaning

Stone Floor, Upholstery & Rug Cleaning.

A few points that make us stand out from the others,

Rothwell's has been in business since 1993.

We're an honest local family firm.

Our large truck mounted machines mean more cleaning
& drying power for the best results possible.

Members of both the NCCA and TACCA.

We will move the furniture for a thorough clean.

100% satisfaction or it's FREE.

Call Oliver and Max Campbell for expert help today.

Rothwell's, Malting End, Kirtling, Newmarket, CB8 9HH



Licensed cloud based bookkeeping practice

Working side by side with entrepreneurs
to take control of their business finances!

Genie Services include:

- ☆ Weekly & Monthly Bookkeeping
- ☆ Payroll Services
- ☆ Preparing & Submitting VAT Returns
- ☆ Cloud Set up & Training
- ☆ Annual Accounts for Sole Traders & Partnerships



+44 7309 600 007

phina@a-counting-genie.co.uk

www.a-counting-genie.co.uk

Bus Times

To / From Bury St Edmunds		Mon	Tue	Wed	Thu	Fri	Sat	Sun
379	OUTWARD	Felsham Six Bells			10:38			
		Gedding Bus Stop			10:41			
		Bury Bus Station			11:07			
	RETURN	Bury Bus Station, Stand 5			12:55			
		Gedding Bus Stop			13:19			
		Felsham Six Bells			13:22			

We provide holistic and realistic support for your health and wellbeing

| Acupuncture | Counselling | Sports & Remedial Massage

| Exercise & Rehabilitation | Personalised Nutrition

| CBT | EMDR | Hypnotherapy | Reflexology

T 01359 408 011

woolpit-complementary.co.uk

Woolpit Complementary

11 Brickfield Business Park, Old Stowmarket Road

Woolpit, IP30 9QS



Woolpit
Complementary

Because your health matters

Village Directory

ALLOTMENTS	BRIAN FRANCIS	01449 736219
ST PETER'S CHURCH, FELSHAM	REVEREND SHARON POTTER	01284 828599
ST MARY'S CHURCH, GEDDING	revsharon2@gmail.com	
CHURCH WARDENS	DAVID WILLIAMS (FELSHAM)	01449 737778
	JAMES MORGAN (GEDDING)	01449 737445
DOCTORS SURGERY	WOOLPIT HEALTH CENTRE, HEATH ROAD, WOOLPIT	01359 240298
PHARMACY	WOOLPIT HEALTH CENTRE, HEATH ROAD, WOOLPIT	01359 242394
F&G Community Store & Post Office		01449 736042
F&G FUEL GROUP	pawilson4@btinternet.com	01449 736330
FACEBOOK	FELSHAM & GEDDING COMMUNITY	
FAGENDS	c/o DAVID WILLIAMS	01449 737778
FELSHAM CHARITY	DAVID WILLIAMS	01449 737778
GEDDING PARISH MEETING	RICHARD VASS - rvass@burland.com	01449 736731
MEMBER OF PARLIAMENT	JO CHURCHILL 10 HATTER STREET, BURY ST EDMUNDS IP33 1LZ	01284 752311
MID SUFFOLK & COUNTY COUNCILLOR	PENNY OTTON penny.otton@suffolk.gov.uk penny.otton@midsuffolk.gov.uk	01449 736482
MID SUFFOLK DISTRICT COUNCIL	NEEDHAM MARKET	0845 606 6170
FELSHAM PARISH COUNCIL	SIMON GARROD, CHAIR	01449 737728
	PAULA GLADWELL, CLERK. GREEN FARM BARN, COCKFIELD felshamparishclerk@gmail.com	01284 828112
PLAYING FIELD	PHILIP COCKELL, CHAIR	01449 736272
SHELTERED HOUSING	MID SUFFOLK DISTRICT COUNCIL	01473 826639
POLICE	SAFER NEIGHBOURHOOD TEAM ONE stowmarket.snt@suffolk.pnn.police.uk	101 999 (emergency)
TABLE TENNIS	ADRIAN KING	01449 737495
TREE WARDEN	MARK TAVERNOR, mtavernor@btinternet.com	01449 737793
VILLAGE E.VINE	faddb1011@btinternet.com	
VILLAGE HALL	ANDREW CONQUEST, CHAIR	01449 737619
	KEN SPARKES, CARETAKER	01449 736373
	DAVID WILLIAMS, BOOKINGS	01449 737778
VILLAGE WEBSITES	FELSHAM: felsham.onesuffolk.net	
	GEDDING: gedding.onesuffolk.net	
WHIST DRIVE	PAT CLARKE	01449 736202
WOMEN'S INSTITUTE	ALISON SHAW	01284 827034
YOGA	PAT CLARKE	01449 736202